



Mi Smart Senor Set User Guide

7 steps to smart life

Global Product Department
国际产品部
Dec. 2018

Mi Smart Sensor Set (Global Version)



- 1 x Control Hub
- 2 x Motion Sensors
- 2 x Window & Door Sensors
- 1 x Wireless Switch

1. Download Mi Home App

- Option 1
 - For Android users: download “Mi Home” from Google Play Store.
 - For iOS users: download “Mi Home” from App Store.
- Option 2
 - Scan the QR code to download and install Mi Home app.



2. Connect to the Network

- Make sure the smartphone is connected to a 2.4GHz WiFi network.
- Power on the Mi Control Hub.

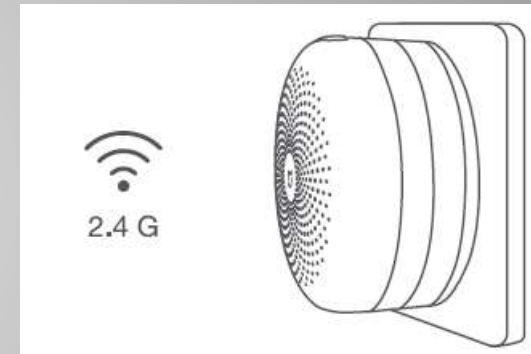

3. Add Devices

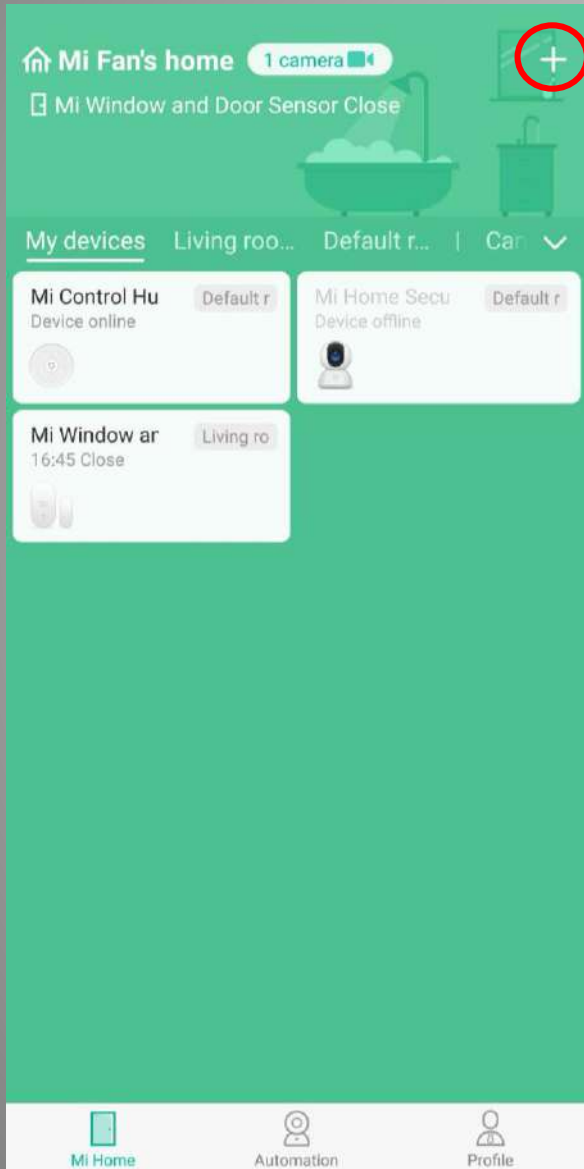

- Open Mi Home app, tap “+” on the upper right, and follow prompts to add devices.
- If not connected, press and hold the button on the hub for 5 seconds until the yellow light fast blinks and then reconnect the device.

4. Find the Mi Control Hub

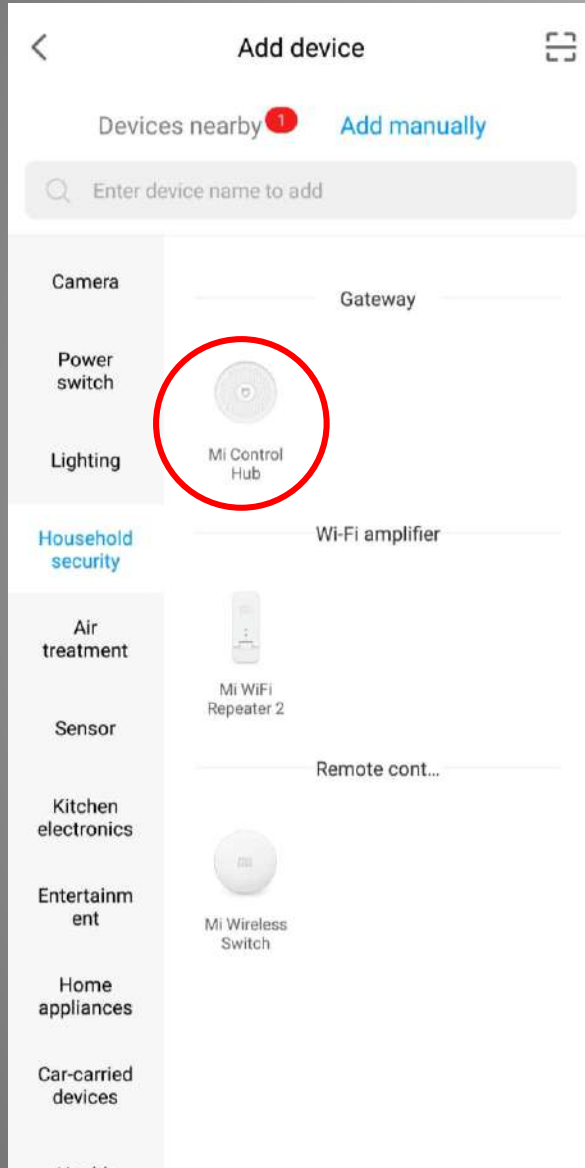

- Option 1
 - Select “Add manually” on the top
 - Go to “Household Security” category
 - Select “Mi Control Hub”

- Option 2
 - Select “Devices nearby” on the top
 - Select “Mi Control Hub” once it is detected

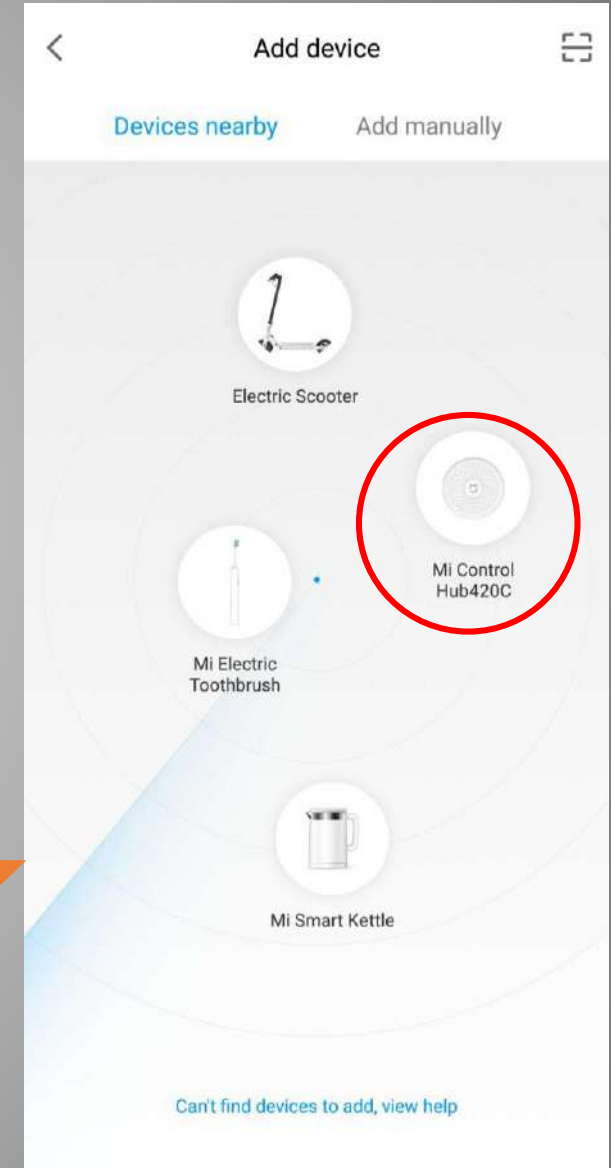

5. Connect the Hub to Network

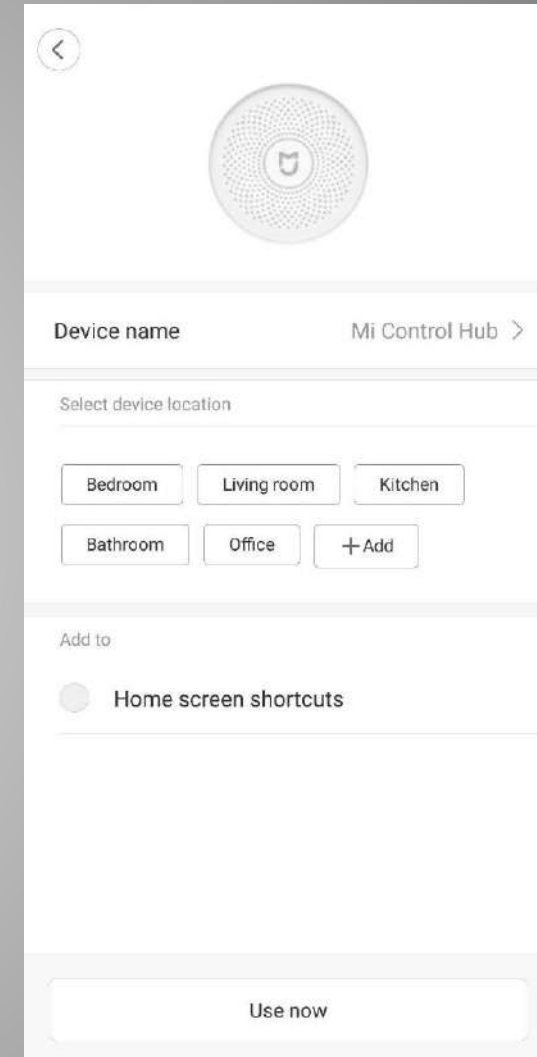
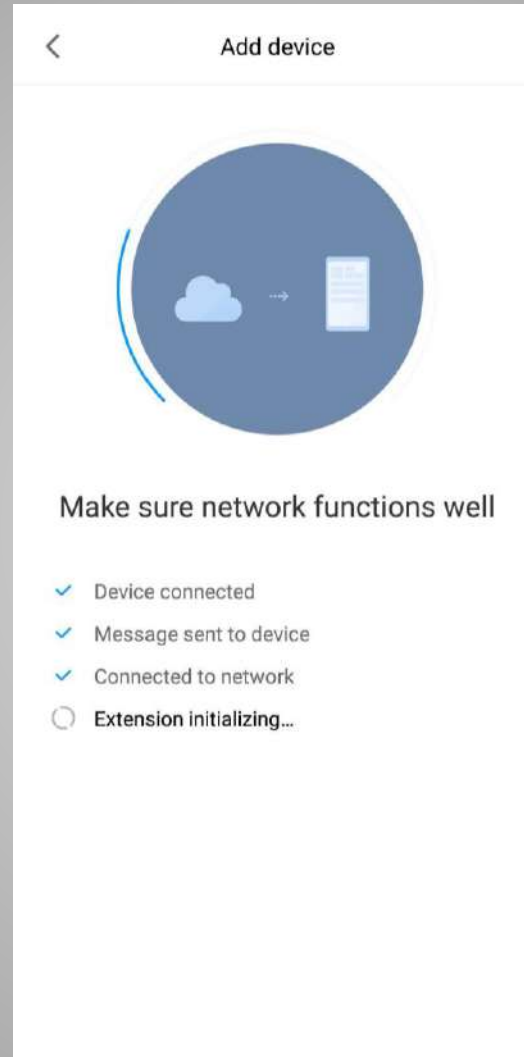
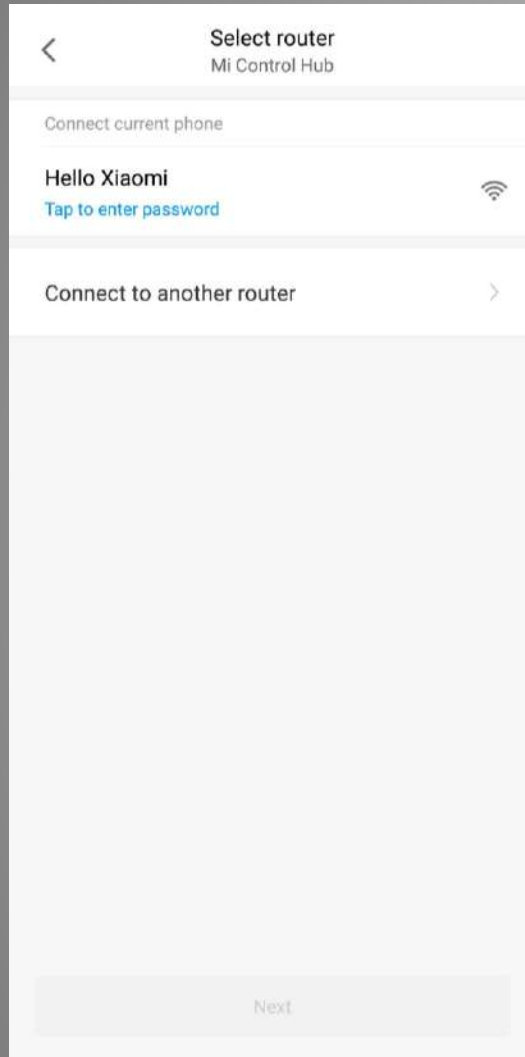

- Select router and input password
- Connect automatically

Multiple Modes of the Hub

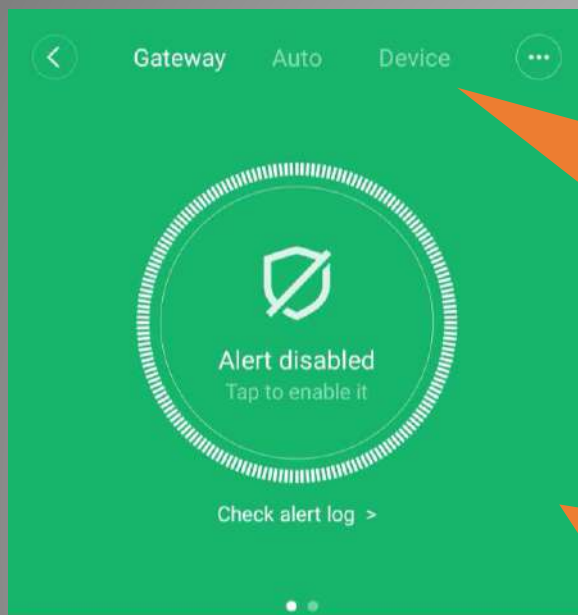

No child device currently Go to [Device](#) to add

- Add a sub-device
 - Option 1: Select “Device” on the top
 - Option 2: Press the power button for 3 times

- Enable ALERT mode
 - Option 1: Tap the shield icon in Mi Home app
 - Option 2: Press the power button twice

- Turn on the night light
 - Option 1: Tap the light icon in Mi Home app
 - Option 2: Press the power button once

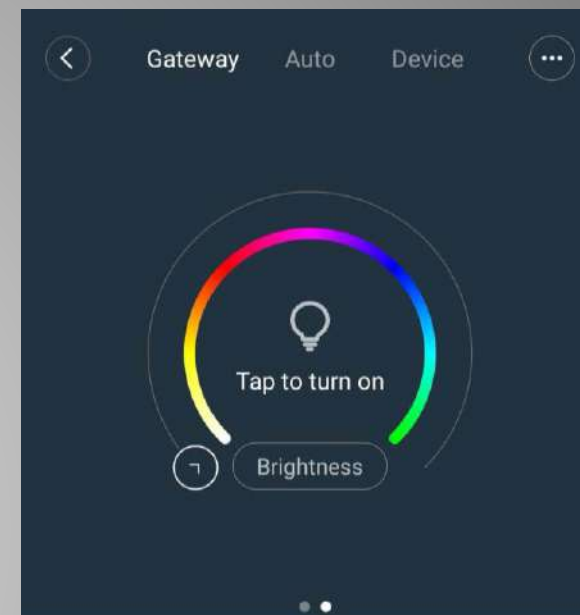

No child device currently Go to [Device](#) to add

6. Add Sensors

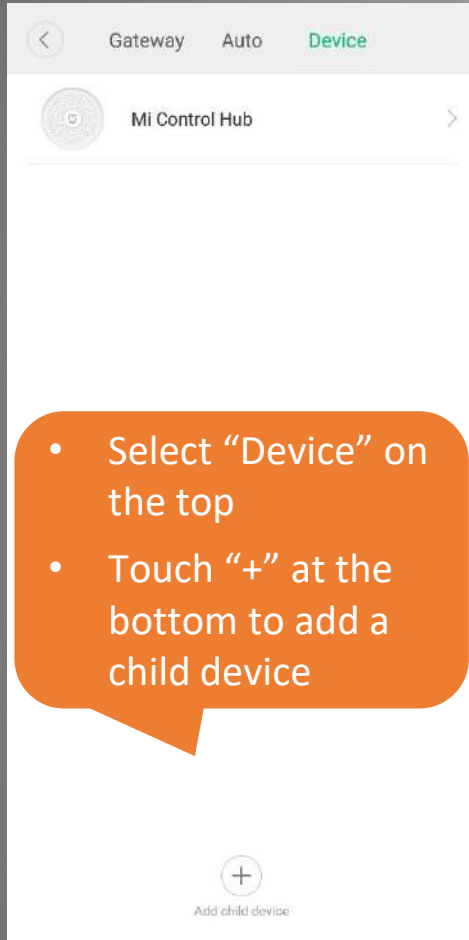

- Select “Device” on the top
- Touch “+” at the bottom to add a child device

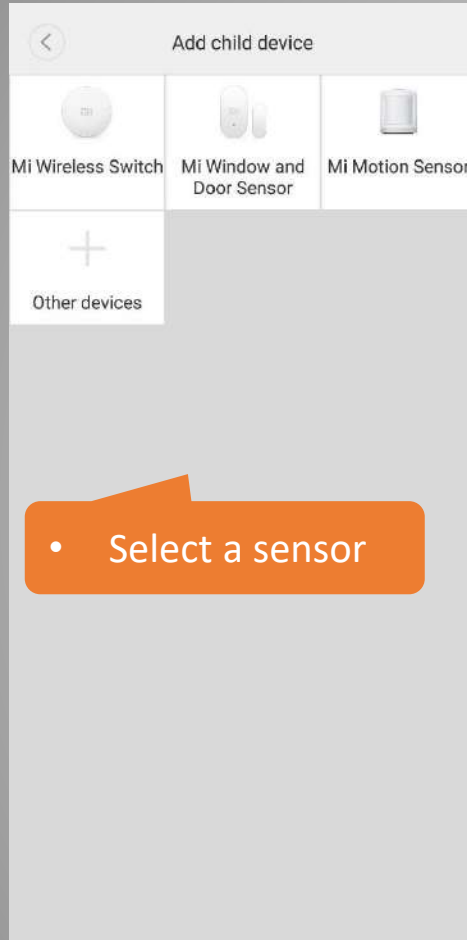

- Select a sensor

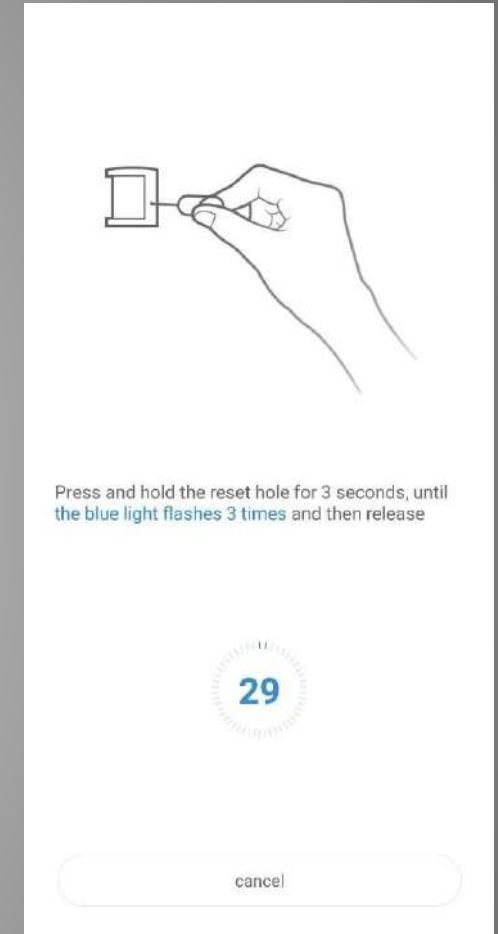
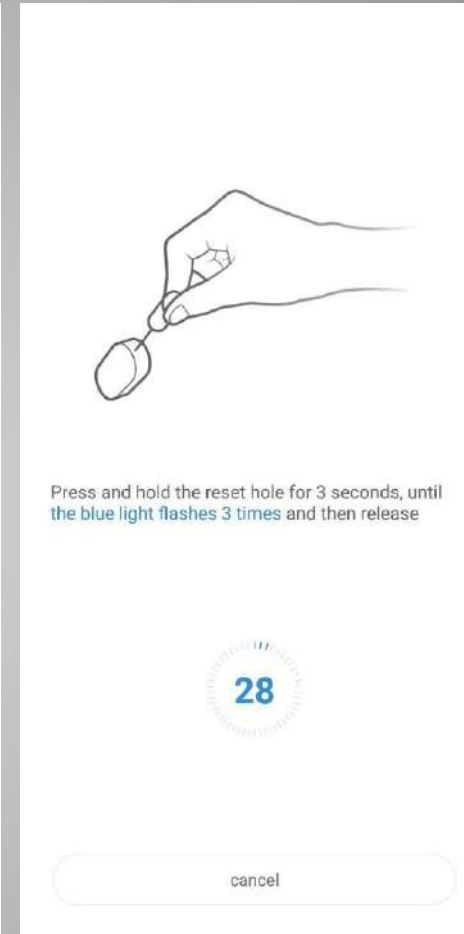
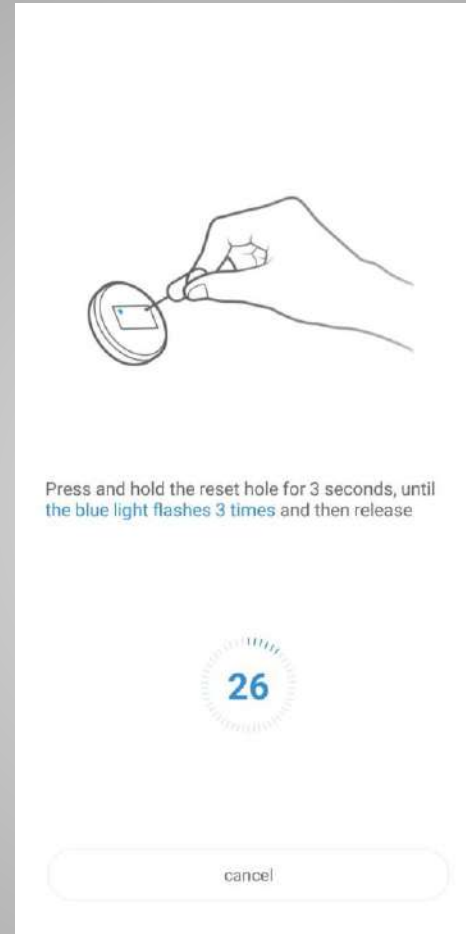

- Follow the instructions to wake the sensors and they will be connected to the Mi Control Hub automatically

6. Add Sensors

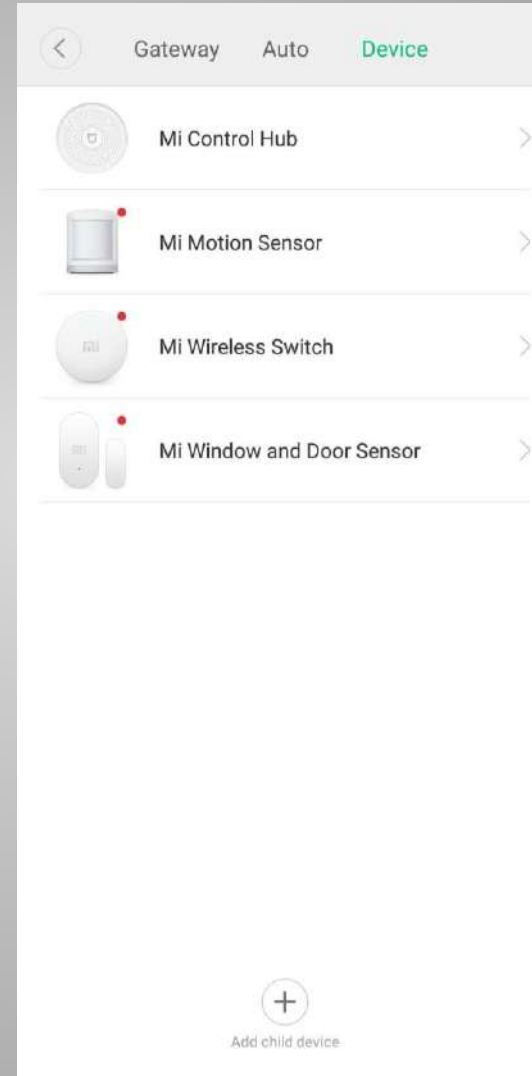
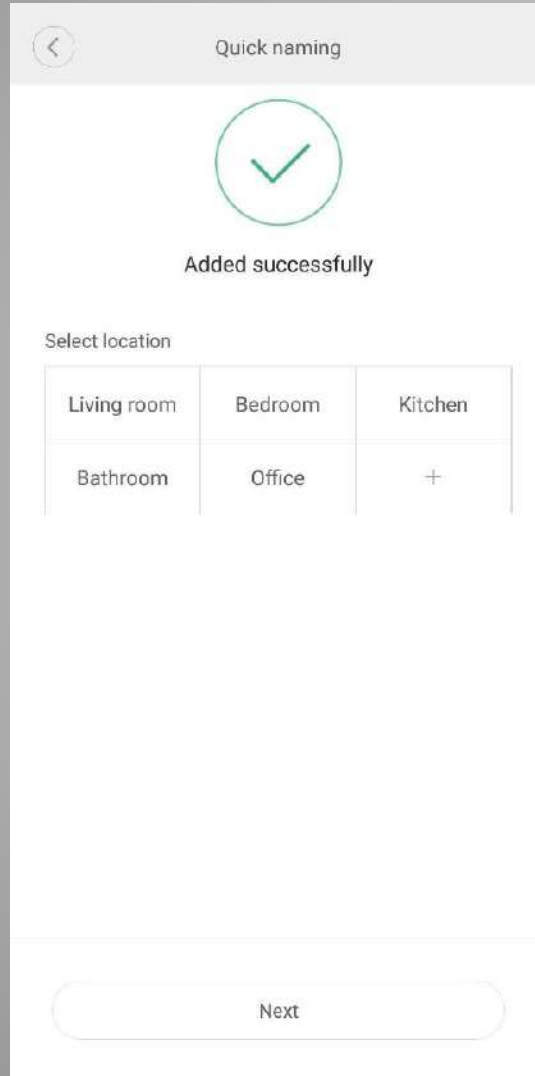
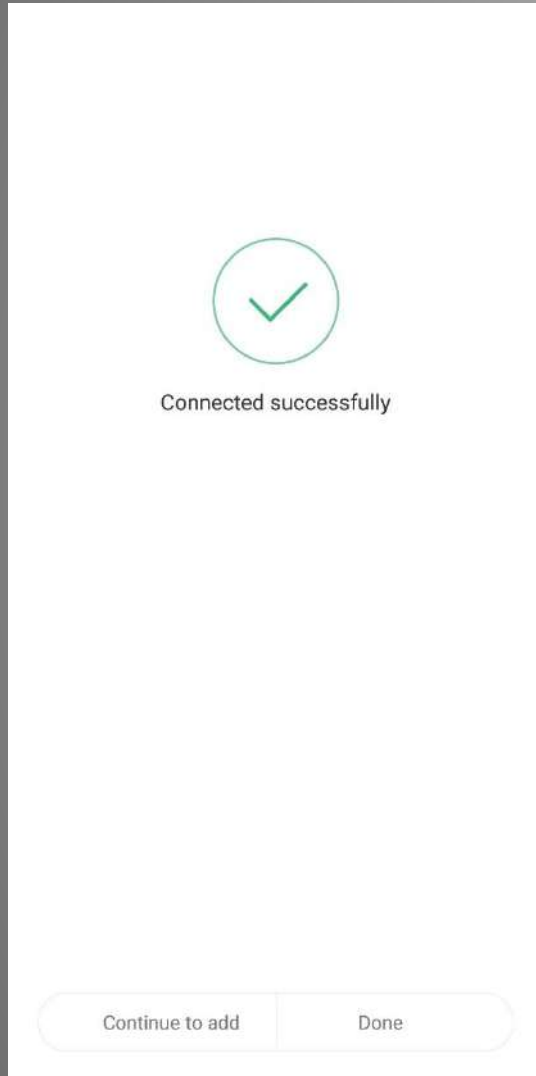

Sensors are connected to the Mi Control Hub

7. Create Smart Home Scenarios

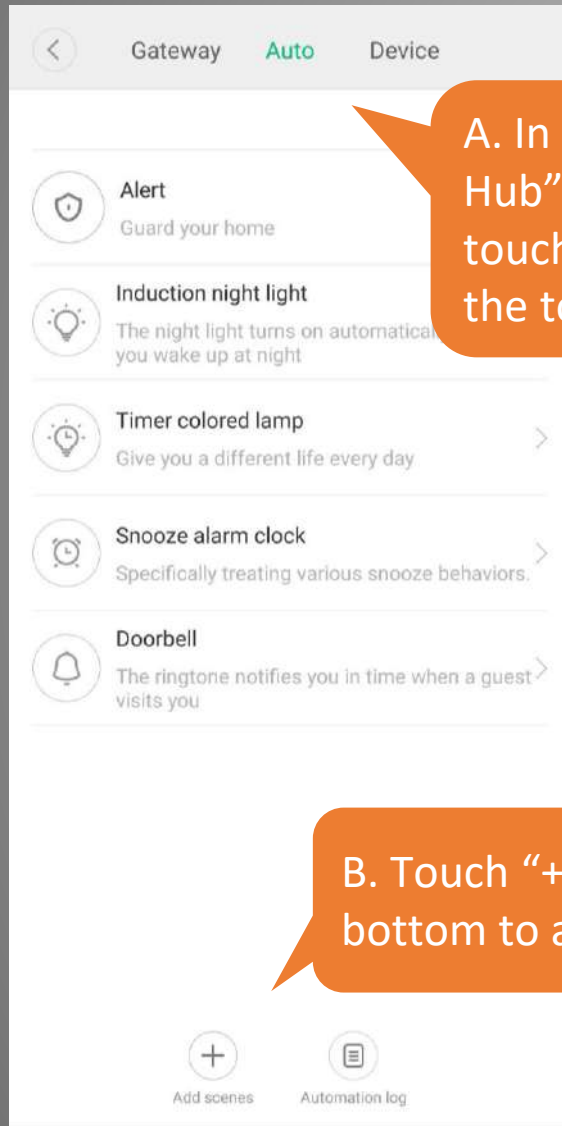

A. In “Mi Control Hub” interface, touch “Auto” on the top.

B. Touch “+” at the bottom to add scenes.

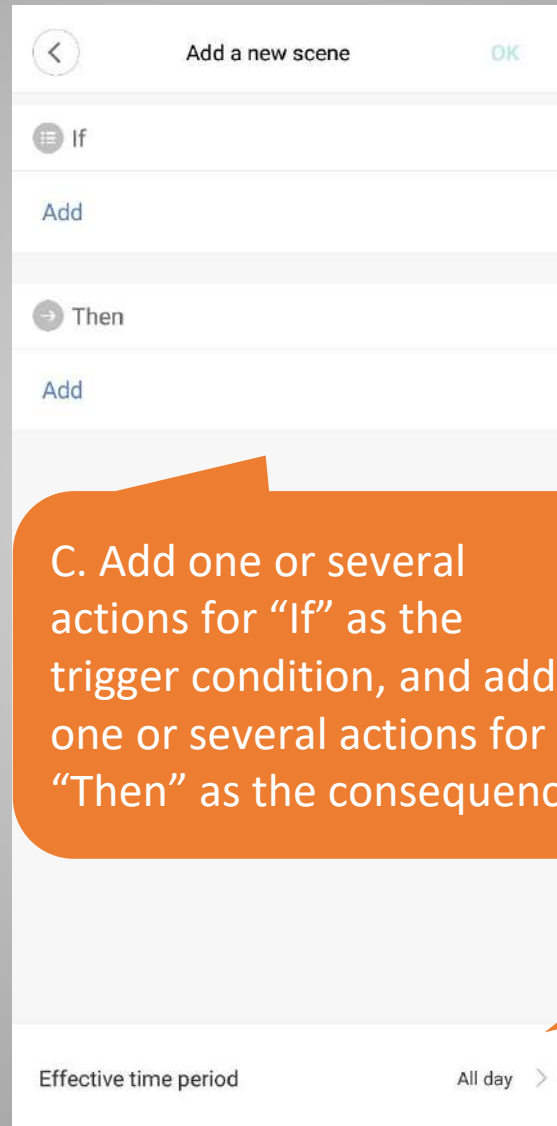

C. Add one or several actions for “If” as the trigger condition, and add one or several actions for “Then” as the consequence.

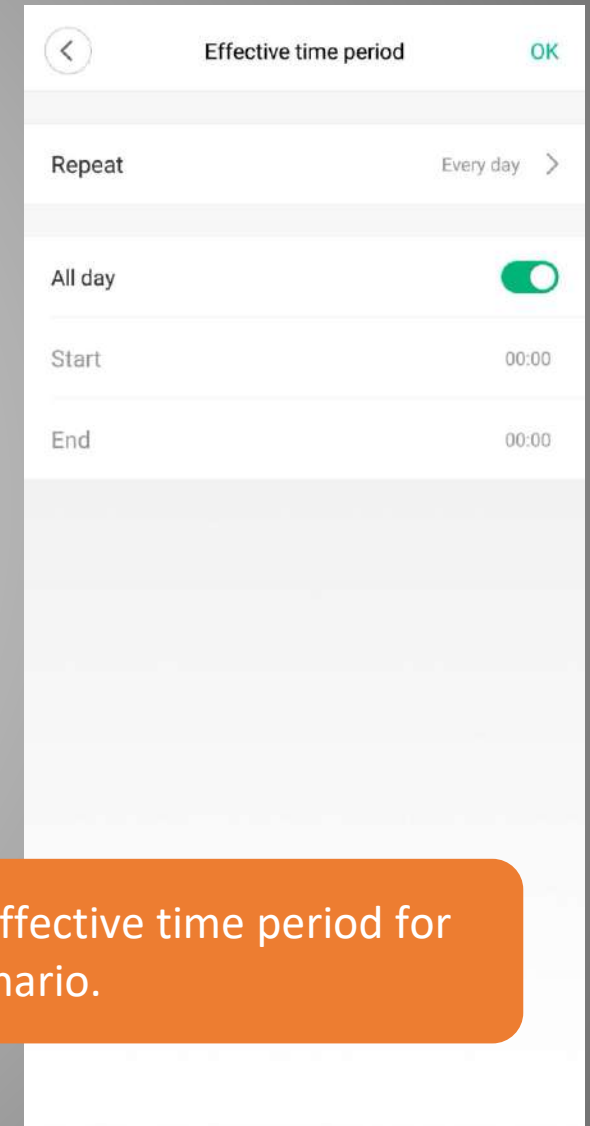

D. Set effective time period for the scenario.

Example



Come home

If

Door/window opens

Mi Window and...
Default room

Add

Then

Turn on

Mi LED Smart Bu...
Default room

Turn on

Mi Air Purifier 2S
Default room

Sleep

Mi Home Securit...
Default room

Add

Effective time period

All day >

Sleep

If

Single press

Mi Wireless Swit...
Default room

Add

Then

Turn off

Mi LED Smart Bu...
Default room

Turn off Hub light

Mi Control Hub
Default room

Switch to Silent mode

Mi Air Purifier 2S
Default room

Add

Effective time period

All day >

Night light

If

Motion detected

Mi Motion Sensor
Default room

Add

Then

Turn on Hub light

Mi Control Hub
Default room

Add

Effective time period

23:00-(The next day)07:00 >

Morning

If

Double press

Mi Wireless Swit...
Default room

Add

Then

Turn on

Mi LED Smart Bu...
Default room

Switch to Auto mode

Mi Air Purifier 2S
Default room

Add

Effective time period

All day >

A. Come home: When the Door & Window sensor detects the door is open, Smart Bulb and Air Purifier will turn on, and the Camera will turn to SLEEP mode.

B. Sleep: Single press the Wireless Switch, Smart Bulb and Hub light will turn off, and Air Purifier will switch to SILENT mode.

C. Night light: When the Motion Sensor detects someone's movement during "Effective time period" at night, the Hub light will turn on, so that it will be convenient for you to drink water or go to toilet at night.

D. Morning: Double press the Wireless Switch, Smart Bulb will turn on and Air Purifier will switch to AUTO mode.

Example

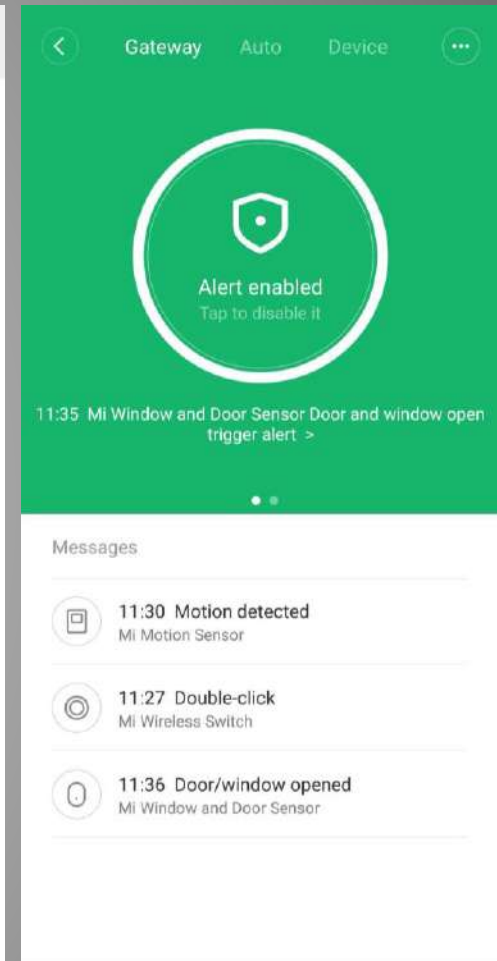
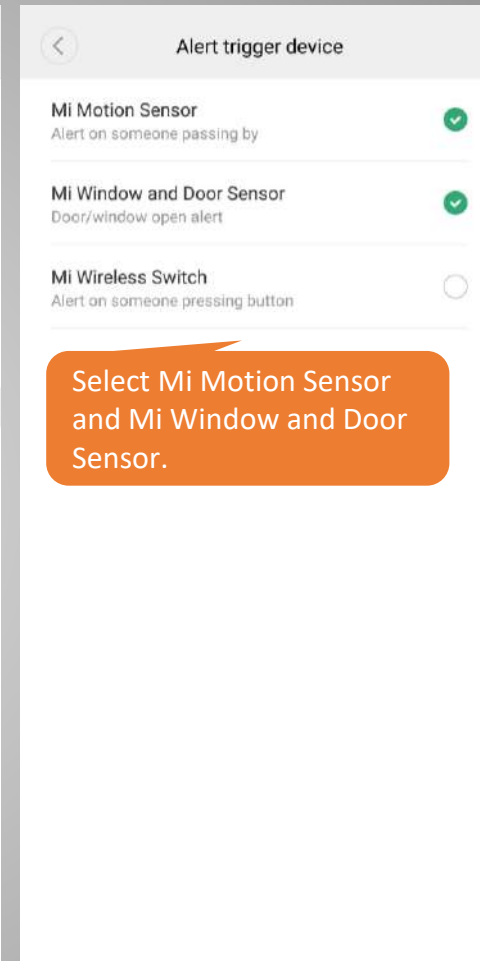
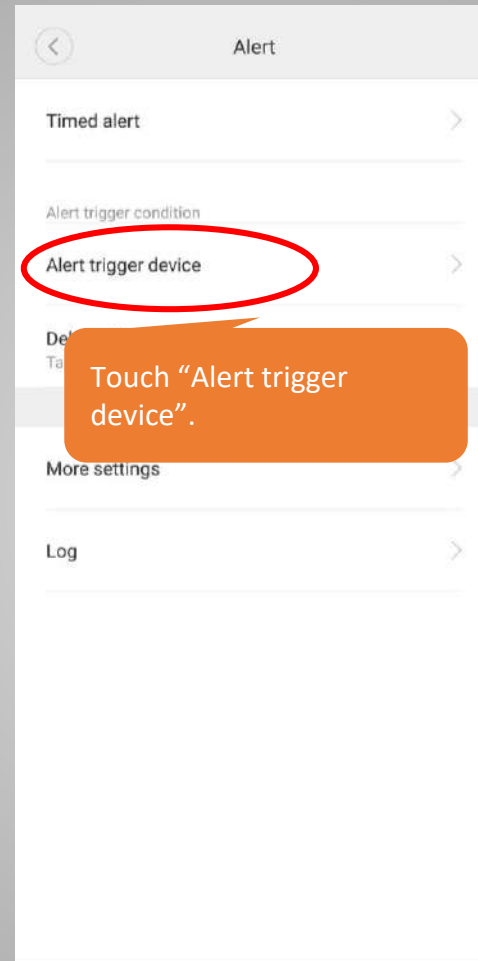
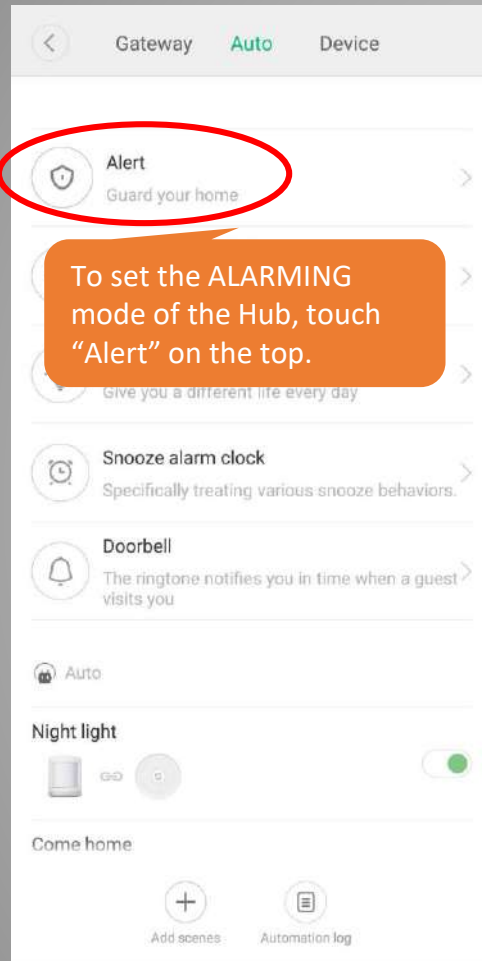
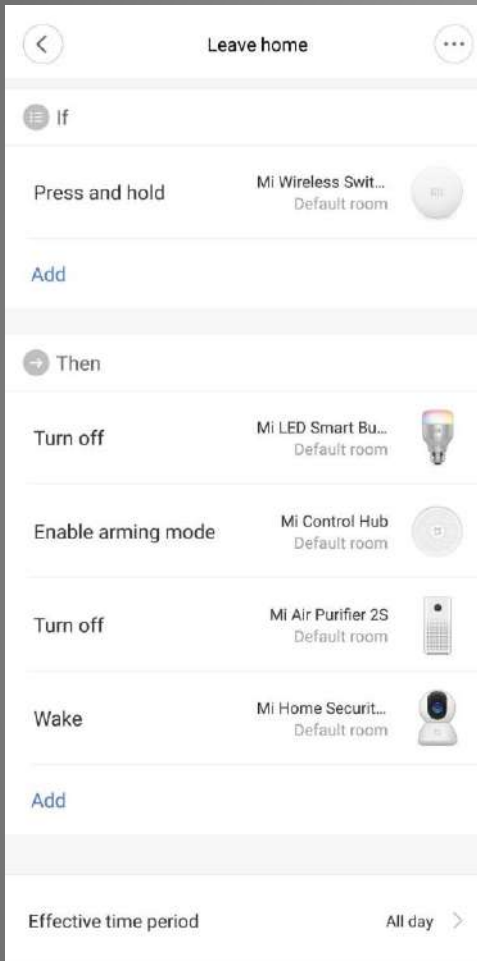

E. Leave home: Press and hold the Wireless Switch, Smart Bulb and Air Purifier will turn off, Hub will turn to ALARMING mode, and Camera will wake up.

Before you get home, please don't forget to disable the Hub's ALARMING mode on Mi Home app.

Example

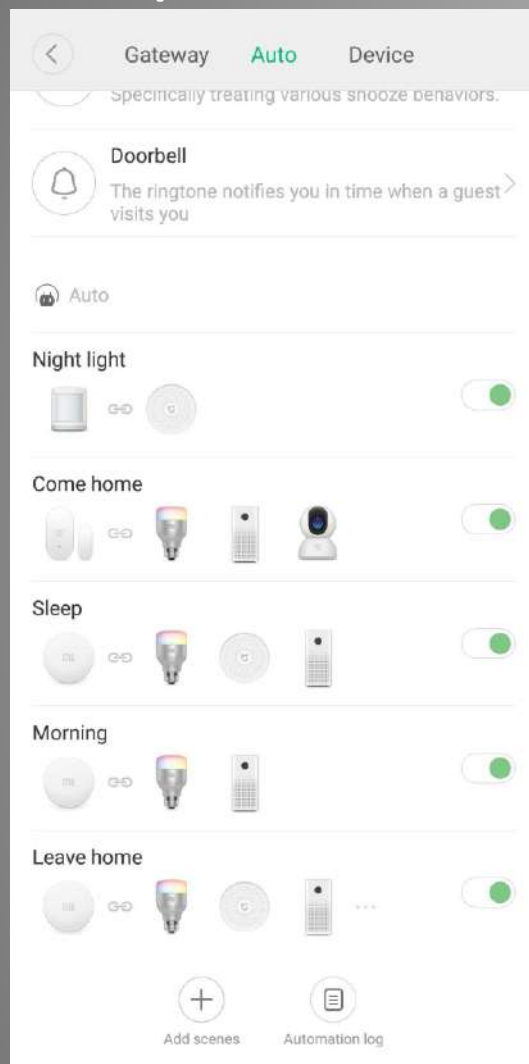

In the "Auto" page, all the scenarios created are listed here.

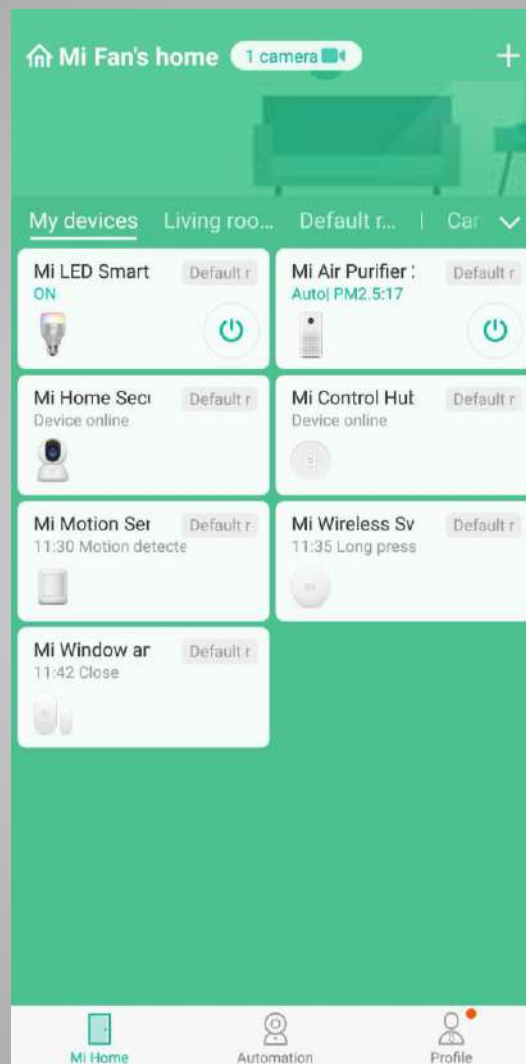

Back to the home page, you can see all the smart devices added to Mi Home app.

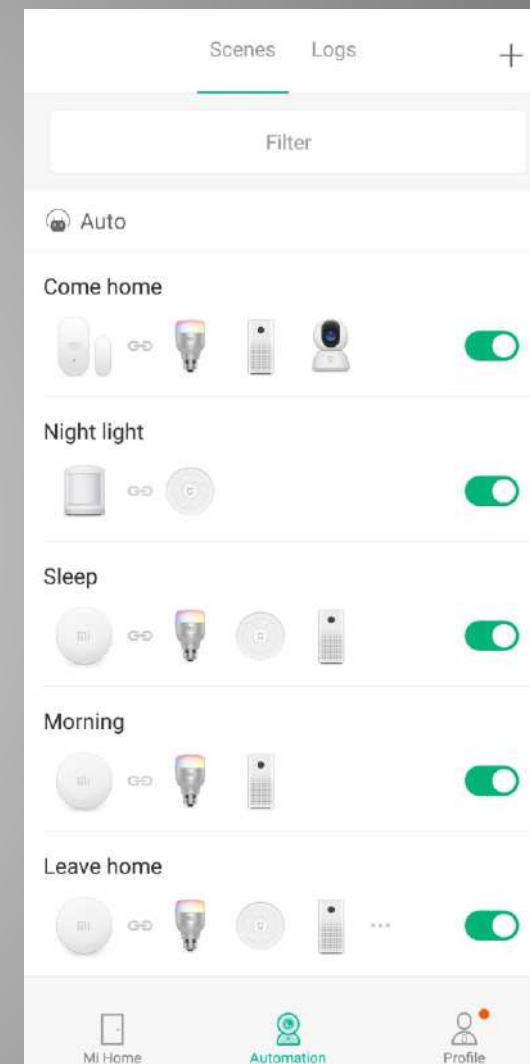

In "Automation" page, you can check and set all the scenarios, too.

Videos



<https://drive.google.com/open?id=1Tdog9EjiHNungAhoZa27wwi6oVOaUJ5m>



<https://www.youtube.com/watch?v=T8xjVYWukrE&t=3s>

Thank you!